

If constructed as stipulated in this manual, the setup will comply with all EU directives.  
 See TÜV report WE06134 for further details.

## FIXED SEAT-BELT ANCHOR POINTS WITH SEAT-BELT RETRACTION UNIT

### Volkswagen T5 without air-conditioning



1) The positions of the seatbelt retractor and the upper belt point are free of choice along the indicated line for mounting. Make sure that the retractor and the upper belt point are as vertical as possible.

Remove the side trim.  
 Remove the head lining.

### Mounting of the upper seatbelt anchorage point in the back



2a) Drill a hole (11 mm) as straight as possible above the retractor in the most upper section of the bodywork above the window as shown in the picture.

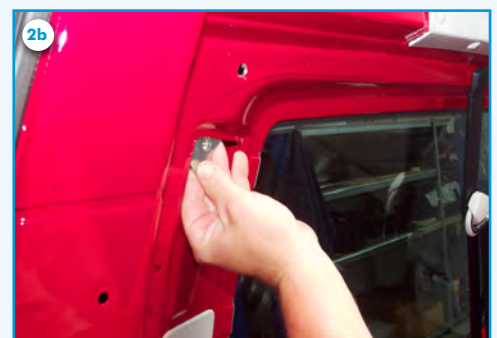

2b) Slide the mounting plate (E) through an existing hole in the body. Line up the hole of the mounting plate with the hole which has just been drilled of 11 mm.



3a) Mount the mounting plate (E) with the matching bolt.



3b) Use another mounting plate for marking the holes to be drilled for the rivets. Drill the holes for the rivets with a 4.2 mm drill.



4a) Mount the mounting plate with the rivets (F). Remove the bolt and mount the side trim.

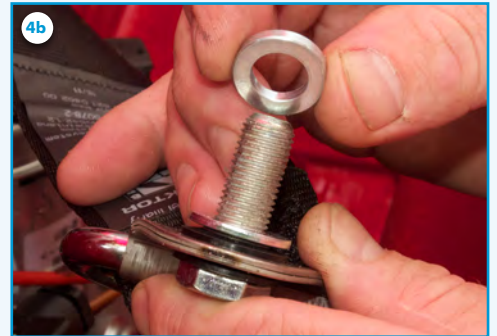

4b) Use the spacers (J) to clear the space between the trim and the body work.

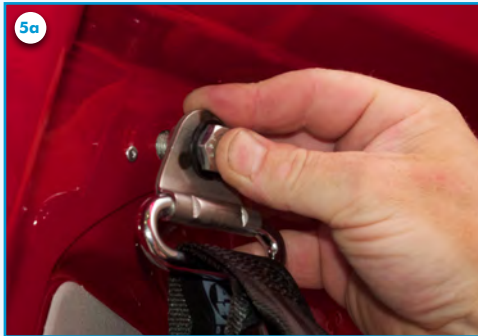

5a) Mount the upper seatbelt point with the corresponding bolt 7/16" UNF 8.8 which is in the mounting kit.



6a) Mount the cover of the upper seatbelt point.



Mounting of the seatbelt retractor (C) behind the wheel arch



7a) Drill a hole of 10.5 mm in the bodywork of the vehicle for mounting the retractor as shown in the picture.

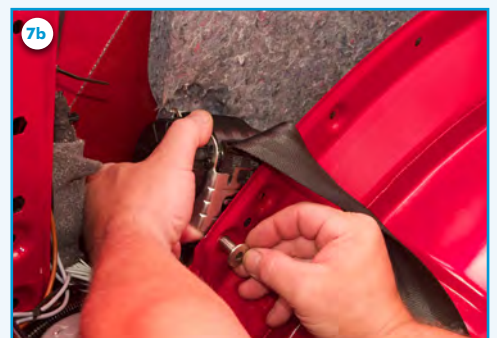

8a) Mount the retractor of the seatbelt with bolt (B) to the bodywork as shown.



Mounting of the side trim with the seatbelt side trim cover



9a) Mark a rectangle of 35 x 64 mm for letting the seatbelt go into the vehicle from behind the side trim.

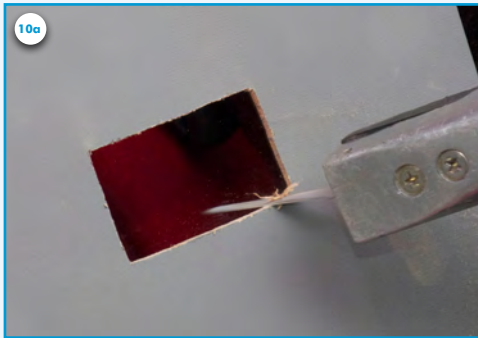

10a) Cut the marked rectangle in the side trim.

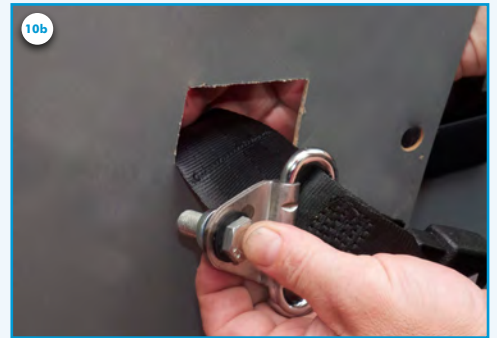

10b) Unscrew the upper seatbelt point and guide the seatbelt through the rectangle hole which has been made in the previous step.



11a) Make a small cut in the side trim seatbelt cover (G). Pull the seatbelt into the side trim cover and mount the cover on to the side trim.



Mounting of the seatbelt retractor (C) in front of the wheel arch



12a) Remove the side trim.



12b) Drill a hole of 10.5 mm as shown.



13a) Mount the seatbelt retractor with bolt (B).



13b) Follow instructions 9a till 11b for mounting the seatbelt side trim cover.

Mounting of the upper seatbelt anchorage point in the front



14a) Determine the correct position of the upper seatbelt anchorage point which is as straight as possible above the upper seatbelt anchorage point above the window.



14b) Drill a hole of 10.5 mm in the bodywork of the vehicle.



15a) Use the mounting plate (E) for marking the holes for the rivets. Drill the holes for the rivets with a 4.2 mm drill.



15b) Mount the upper seatbelt anchorage point with the 7/16" UNF 8.8 bolt which is provided in the mounting kit.

Mounting of the seatbelt tongue



16a) To prevent swinging of seat belts which are not in use a seat belt tongue can be mounted.



16b) Drill two holes of 5.1 mm for mounting the seatbelt tongue (H).



17a) Mount the seatbelt tongue with the rivets (I).

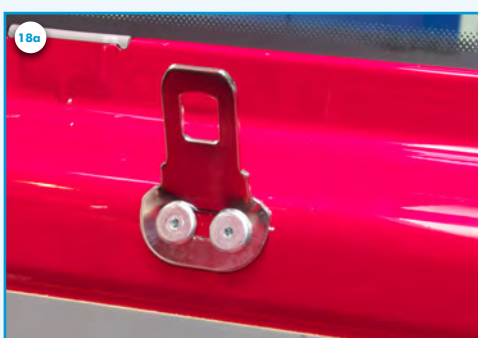
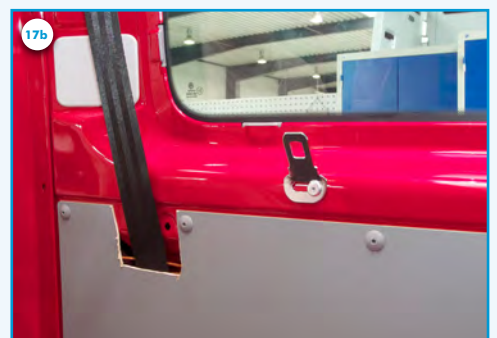

18a) Bend the seatbelt tongue a little bit if necessary.



18b) Click the loose seatbelt to the seatbelt tongue.